

100  
10  
0  
A1

DO NOT SCALE

File: 5214419-ATK-01-ZZ-DR-CE-2701\_2704.dwg  
Date: Sep 12, 2022 - 3:52pm  
Printed by: patrick.sheridan

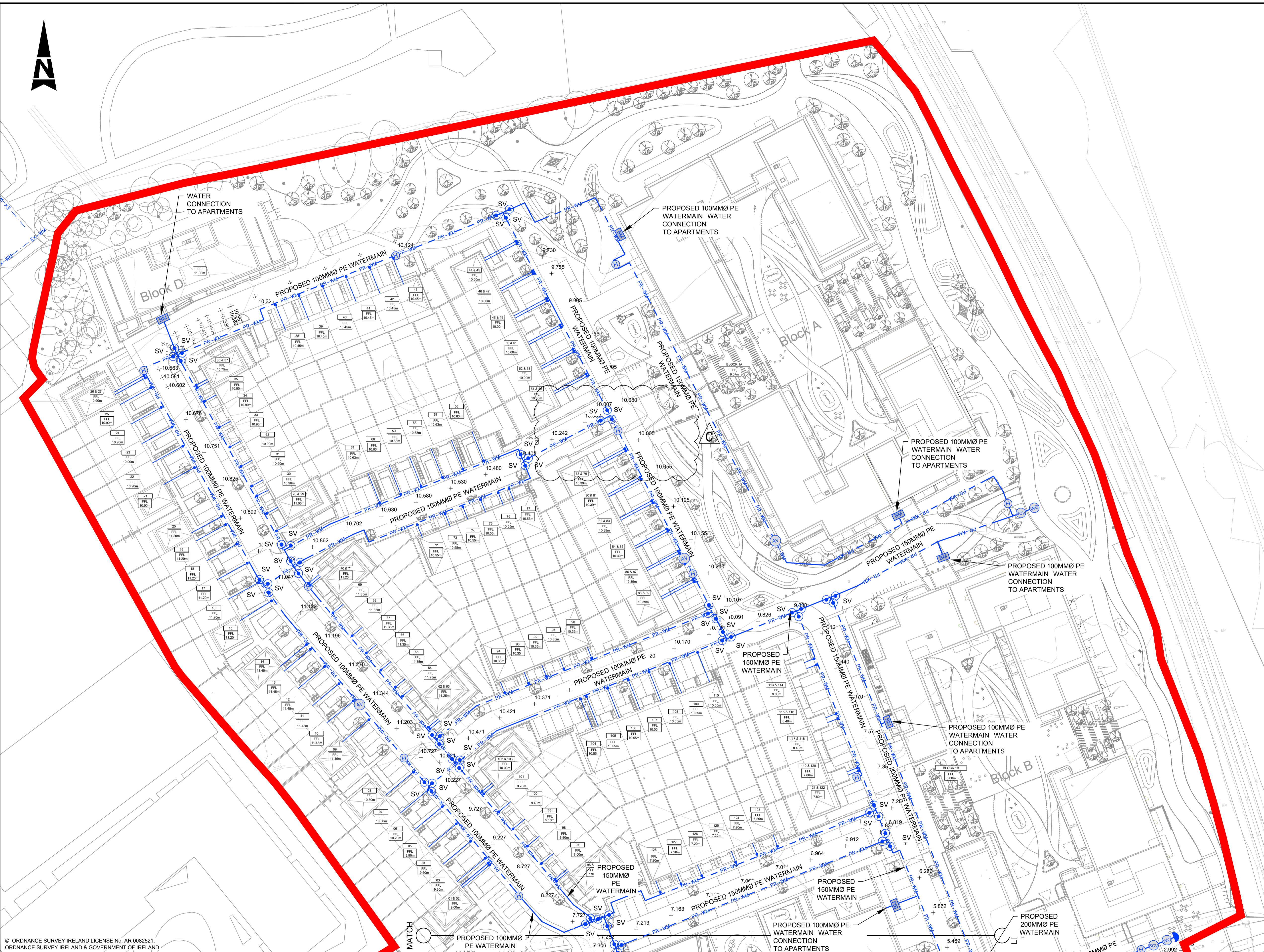

- GENERAL NOTES**
1. ALL DIMENSIONS ARE IN MILLIMETRES UNLESS NOTED OTHERWISE
  2. ONLY WRITTEN DIMENSIONS SHALL BE USED. NO DIMENSIONS SHALL BE SCALED FROM THE DRAWINGS
  3. ALL LEVELS ARE IN METRES AND ARE TO MALIN HEAD DATUM
  4. ALL COORDINATES ARE IN METRES AND ARE TO IRISH TRANSVERSE MERCATOR

FINAL LAYOUT AS AGREED WITH IRISH WATER IN THE STATEMENT OF DESIGN ACCEPTANCE (REF NO.CDS22005393)

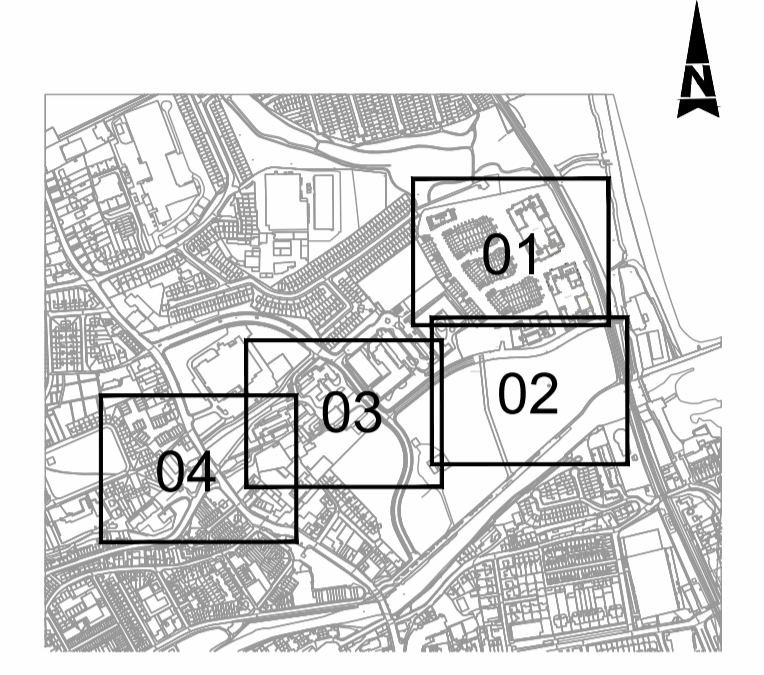

**KEY PLAN**  
Scale NTS

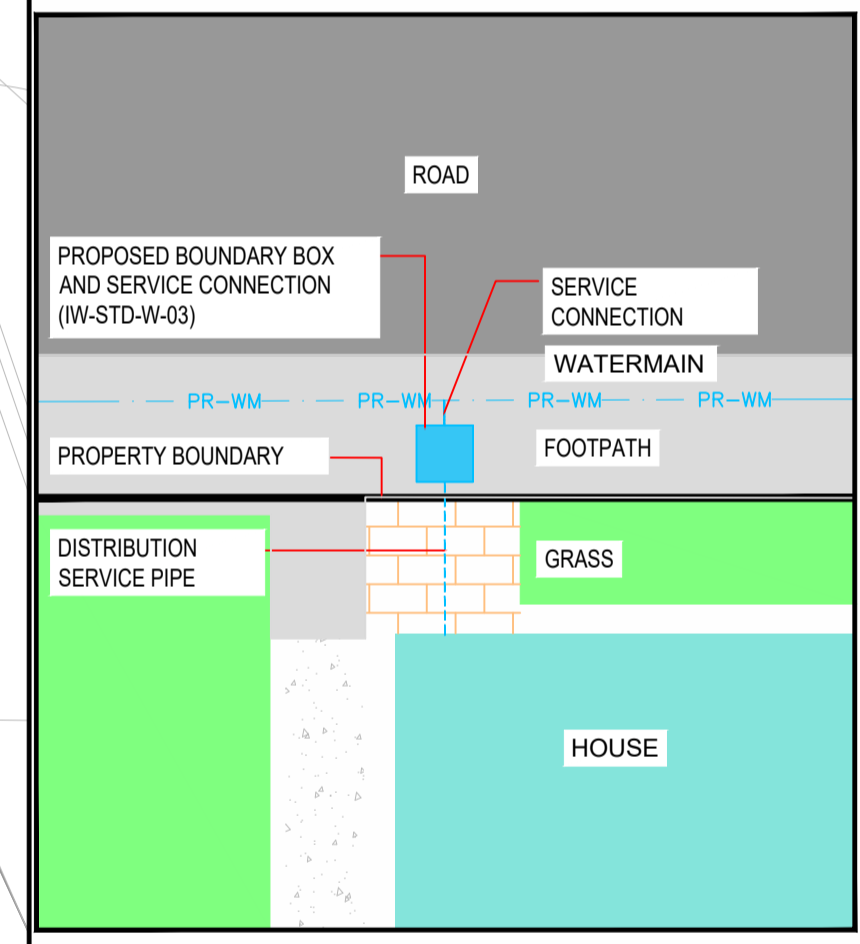

**TYPICAL BOUNDARY BOX DETAIL**  
Scale at A1 1:100

**NOTE:**  
INSTALLATION OF WATER MAIN SHALL BE IN ACCORDANCE WITH IRISH WATER, WATER INFRASTRUCTURE STANDARD DETAILS (IW-CDS-5020-01) & CODE OF PRACTICE FOR WATER INFRASTRUCTURE (IW-CDS-5020-03)  
INSTALLATION OF WATER MAIN AND ALL OTHER DEVELOPMENT SERVICES SHALL BE IN ACCORDANCE WITH IRISH WATER STD-W-11  
AIR VALVE AND HYDRANTS COVERS, WHERE LOCATED IN GRASS AREAS, SHALL BE SURROUNDED BY A CONCRETE PLINTH, 200MM ALL ROUND AND 100MM DEEP FORMED WITH C20/25 CONCRETE, 20MM AGGREGATE SIZE, BEDDED IN CLAUSE 804 MATERIAL. THE PLINTH SHALL INCORPORATE MILD STEEL REINFORCEMENT LINKS AND SHALL HAVE A BULL-NOSE FINISH AROUND ITS EXTERNAL PERIMETER. SEE SECTION 3.18 OF WATER CODE OF PRACTICE A GEOTEXTILE PIPE WRAP ROOT PROTECTION SYSTEM WILL BE APPLIED TO THE PIPES WHERE IT IS LAID WITHIN THE MINIMUM DISTANCE GIVEN IN TABLE A1 OF BS 5837 AS SPECIFIED IN SECTION 3.26 OF THE IRISH WATER CODE OF PRACTICE FOR WATER INFRASTRUCTURE

© ORDNANCE SURVEY IRELAND LICENSE No. AR 0082521  
ORDNANCE SURVEY IRELAND & GOVERNMENT OF IRELAND

LEGEND	
— EX-WM —	EXISTING WATERMAIN
— PR-WM —	PROPOSED (HPP/HDPE PE-100 SDR-17) WATERMAIN DIAMETER AS INDICATED
SV	PROPOSED SLUICE VALVE (IW-STD-W-15)
H	PROPOSED FIRE HYDRANT (ONLINE IW-STD-W-18) (OFFLINE IW-STD-W-19)
BM	PROPOSED BULK METER (IW-STD-W-26)
— OD —	PROPOSED 25MM (OD) PE SERVICE PIPE AS PER STD-W-01
AV	PROPOSED AIR VALVE (ONLINE IW-STD-W-22) (OFFLINE IW-STD-W-23)
SCV	PROPOSED SCOUR VALVE (IW-STD-W-30)
MC	PROPOSED MANIFOLD CHAMBER (IW-CDS-5020-03, SECTION 3.14)
EC	PROPOSED END CAP (IW-STD-W-05)
WHD	PROPOSED WASH OUT HYDRANT (IW-STD-W-30A)
— RB —	SITE BOUNDARY

Rev	Description	By	Date	Chk'd	Auth
C	ISSUED FOR PLANNING	PS	06.09.22	AC	GH
C	ISSUED FOR IW REVIEW	PS	24.08.22	AC	GH
B	ISSUED FOR IW REVIEW	PS	23.08.22	AC	GH
A	ISSUED FOR IW REVIEW	PS	02.08.22	AC	GH
-	FOR INFORMATION	PS	26.05.22	AC	GH

**ATKINS**  
Member of the SNC-Lavalin Group

Atkins House, 150-155 Ainslie Road, Unit 2B, 2200 Cork Airport Business Park, Cork  
Tel (+353) 01 810 8000 Fax (+353) 01 810 8001

1st Floor Technology House Parkmore Technology Park, Galway  
Tel (+353) 021 429 0300 Fax (+353) 021 429 0360

Client	SHANKILL PROPERTY INVESTMENTS LTD
Project	COASTAL QUARTER SHD 2

Purpose	PLANNING
Title	PROPOSED WATERMANS LAYOUT SHEET 1 of 4
Original Scale	1:500 at A1 1:1000 at A3
Design/Drawn	PS
Checked	AC
Authorized	GH
Date	26.05.22
Date	26.05.22
Date	26.05.22
Status	P
Drawing Number	5214419-ATK-01-ZZ-DR-CE-2701
Rev	C